

QUANTUM[®]

BSP30PTSC

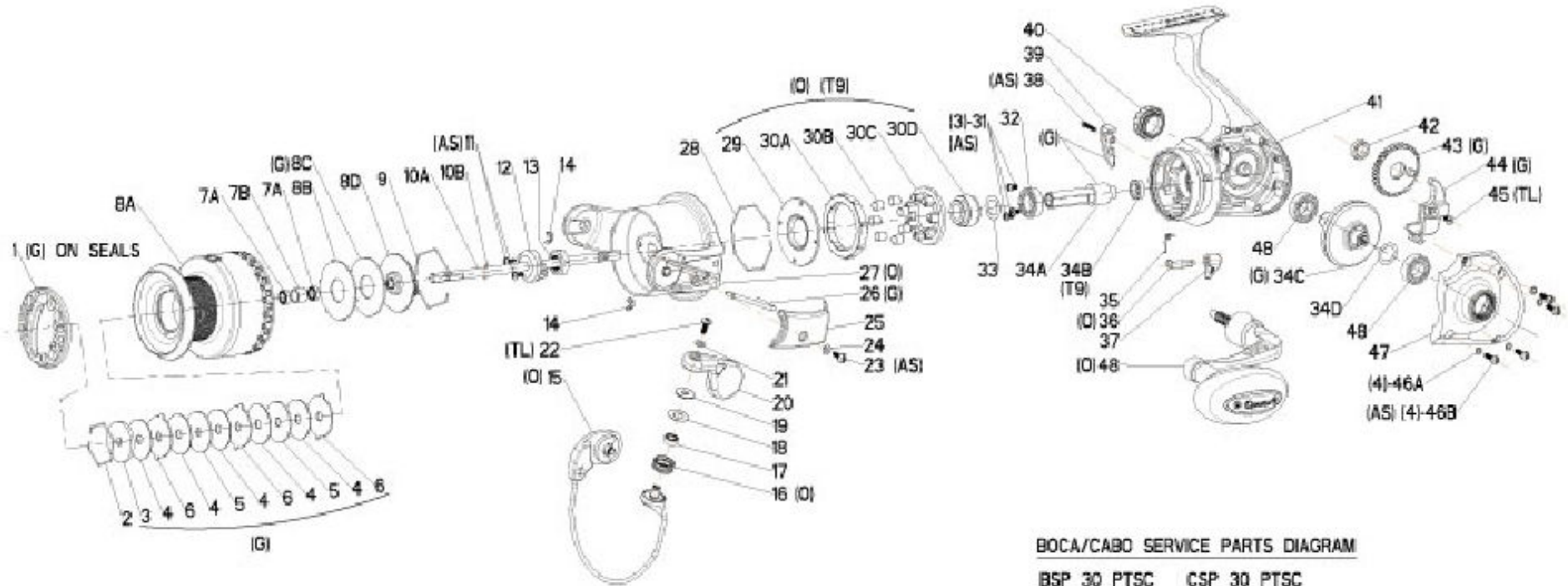

BOCA/CABO SERVICE PARTS DIAGRAM

BSP 30 PTSC	CSP 30 PTSC
BSP 40 PTSC	CSP 40 PTSC
BSP 50 PTSC	CSP 50 PTSC
BSP 60 PTSC	CSP 60 PTSC
BSP 80 PTSC	CSP 80 PTSC

(OI) : OIL - HOT SAUCE
 (GI) : GREASE - HOT SAUCE
 (ASI) : ANTI-SEIZE (ON SCREW THREADS)
 (TL) : THREAD LOCKING COMPOUND (ON SCREW THREADS)
 (T9) : ANTI-CORROSION LUBRICANT

QUANTUM[®]

BSP30PTSC

Quantum BSP30PTsC Spinning Reel Part List

Key #	Description	Part No.	Key #	Description	Part No.
1	DRAG KNOB ASSEMBLY	AT332-01	24	WASHER - ARM LEVER COVER	SQ142-01
2	RETAINER CLIP	RQ038-01	25	ARM LEVER COVER	TQ087-01
3	DRAG WASHER "D"	SQ080-03	26	KICK LEVER	TQ019-01
4	DRAG WASHER "B" - FRICTION	RQ033-01	27	ROTOR ASSEMBLY	TQ309-03
5	DRAG WASHER "D"	RQ080-01	28	RETAINER CLIP - CLUTCH	PAA038-01
6	DRAG WASHER "A"	RQ081-01	29	SEAL - CLUTCH	PAA166-01
7	SPOOL BUSHING OR BEARING KIT	AT4160-01	30	CLUTCH ASSEMBLY KIT	PAA4363-01
	7A - SPOOL BUSHING OR BEARING (2)	IN KIT		30A - CLUTCH LOCK RING	IN KIT
	7B - SPOOL SPACER	IN KIT		30B - CLUTCH ROLLER (6)	IN KIT
8	SPOOL ASSEMBLY KIT	AT4321-02		30C - CLUTCH RETAINER	IN KIT
	8A - SPOOL ASSEMBLY	AT221-02		30D - CLUTCH SLEEVE	IN KIT
	2 - SPOOL RETAINER - TOP	IN KIT	31	SCREW (3)	TK057-01
	3 - DRAG WASHER "D" (1)	IN KIT	32	BALL BEARING - PINION	UK028-01
	4 - DRAG WASHER "B" (3) - FRICTION	IN KIT	33	WASHER - PINION	AT110-01
	5 - DRAG WASHER "D" (1)	IN KIT	34	GEAR KIT	SQ4011-01
	6 - DRAG WASHER "A" (2)	IN KIT		34A - PINION GEAR	IN KIT
	7 - SPOOL BUSHING OR BEARING KIT	IN KIT		34B - PINION BUSHING	IN KIT
	8C - SPOOL WASHER	IN KIT		34C - DRIVE GEAR ASSEMBLY	IN KIT
	8D - DRAG CLICK ASSEMBLY	IN KIT		34D - D.GEAR ADJUST WASHER	IN KIT
	9 - SPOOL RETAINER - BOTTOM	IN KIT	35	SPRING - ANTI-REVERSE	TK089-01
9	RETAINER CLIP	AT036-01	36	ACTUATOR - ANTI-REVERSE	BT090-01
10	MAIN SHAFT KIT	AT4015-01	37	LEVER - ANTI-REVERSE	RQ059-01
	10A - MAIN SHAFT	IN KIT	38	SCREW - TRIP RAMP	AT136-01
	10B - MAIN SHAFT PIN	IN KIT	39	TRIP RAMP	SQ243-01
11	SCREW - ROTOR NUT	RQ094-01	40	HANDLE CAP ASSEMBLY	AT373-01
12	MAIN SHAFT BUSHING	SQ214-01	41	BODY ASSEMBLY	AT301-04
13	NUT - ROTOR	TH006-01	42	O/S GEAR BUSHING OR BEARING	RQ158-01
14	E-CLIP	GH034-01	43	GEAR - OSCILLATOR	TQ053-01
15	BAIL ASSEMBLY	AT347-02	44	OSCILLATOR SLIDER	SQ025-01
16	LINE ROLLER	CH004-02	45	SCREW - MAIN SHAFT	RQ100-01
17	BALL BEARING - LINE ROLLER	GH202-01	46	BODY COVER SCREW KIT	AT4057-01
18	WASHER - LINE ROLLER	DH102-01		46A - SCRATCH PROTECT WASHER (3)	IN KIT
19	LINE ROLLER COLLAR	CH102-01		46B - BODY COVER SCREW (3)	IN KIT
20	ARM LEVER ASSEMBLY	SQ307-04	47	BODY COVER	SQ023-07
21	WASHER - SCRATCH PROTECTION	PAA065-01	48	BALL BEARING - BODY	BL157-01
22	SCREW - LINE SLIDER	AQ108-01	49	HANDLE ASSEMBLY	PAA318-01
23	SCREW - ARM LEVER COVER	GU077-02			